



RAJASTHAN STATE MINES & MINERALS LIMITED

(A Government of Rajasthan Enterprise)

Corporate Office : 4- Meera Marg, UDAIPUR – 313 001,

Phone : 0294 – 2428768 - 85, 2428744, Fax: 0294-2428790

Ref. no :- RSM/CO/Proj/TD/Corri-2(2018-19/22)/18-19

Dated. 08.05.2018

CORRIGENDUM NO. 2

Sub : Consultancy Services for Design, Survey, Detailed Project Report Preparation, Tender Document Preparation and supervision for creation of additional pondage capacity by raising dam height utilizing inside material of Existing Tailing Dam located near Base Camp at Jhamarkotra Mines, Distt.- Udaipur

Ref. : e- Tender No. RSM/CO/Proj/TD/2018-19/22 dated 12.04.2018

With reference to the above referred tender, kindly note the following amendments in the tender document:

S. No.	Clause no.	Amendment
1	Pre-Qualification criteria in DNIT & clause no. 3.40 (iii) of tender document & mentioned elsewhere in the tender document	Existing clause of PQC is substituted as : Tenderer shall be pre qualified on the basis of criteria mentioned below 1) <i>“The bidder should have annual turnover of Rs.5 Lakh or more in any of the immediate preceding four financial years i.e. 2014-15, 2015-16, 2016-17 & 2017-18 in its own name.”</i>
2	Clause no.4.4 of tender document.	Following is added in the clause as: 1) <i>“Site/present setup drawing is available at Annexure-IX. The prospective bidders may contact us and visit us for seeing larger view of detailed drawing. ”</i>
3	Clause no. 4.5 of tender document	Following is added in continuation of the clause as: 1) <i>“The minimum effective embankment after excluding 1.0m freeboard would be 5.0m, however, the consultant will submit feasibility & cost benefit analysis, in cases for raising height up to 8m with sensitivity analysis for every 0.5m beyond 5.0 .”</i>
4	Section II, of tender document	Clause named Site conditions in Section II is added as: 1) <i>“The available decantation arrangement is working satisfactorily, however, rest of the exercise about structural and hydraulic design etc. are to be worked out by the consultant himself.”</i>
5	New Clause no.4.4 of tender document	Following is added in the clause as: <i>“Details of Tailing/Slurry are as under:</i> 1) <i>Maximum tailing produce is 1800 MT per day & Average tailing produce is 1200 MT per day.</i> 2) <i>Density of tailings slurry is 1.3 kg/litre (average).</i> 3) <i>Number of production days per year is 300 days (average).</i>

		4) <i>Tailing deposit is classified as soil, refer Annexure –X. the prospective bidder may also collect the sample from Jhamarkotra site and get it tested for his purpose.</i>
6	New definition named Waste rock stability buttress in Section-I, of tender document	Following definition is added in the clause as: 1) <i>“Waste rock stability buttress means (A low cost ‘toe filter’ like structure made up of waste rock either generated from mining activities or from excavation activities at site provided at downstream toe of earthen dyke also providing stability against lateral displacement.)”</i>
7	DNIT of tender document	Following is added in DNIT of tender as: 1) <i>“Joint ventures/consortium/ partnership are allowed to participate in this tender subject to the joint/several responsibility, in such cases the cumulative turnover of partners/members will be considered.”</i>
8	New Clause no.9.28 of tender document	Following is added in the clause as: 1) <u>Regulatory and other approvals</u> <i>“RSMML would seek approval from the concerned regulatory authority,if required to do so.</i> <i>All the approvals at RSMML’s end will be forwarded to the consultant under the signature of GGM (Project) or his nominated person.”</i>

All other terms & conditions of the tender shall remain same. The bidders are also requested to upload duly signed copy of Corrigendum along with their offer.

Yours faithfully

Group General Manager (Project)

Annexure - IX

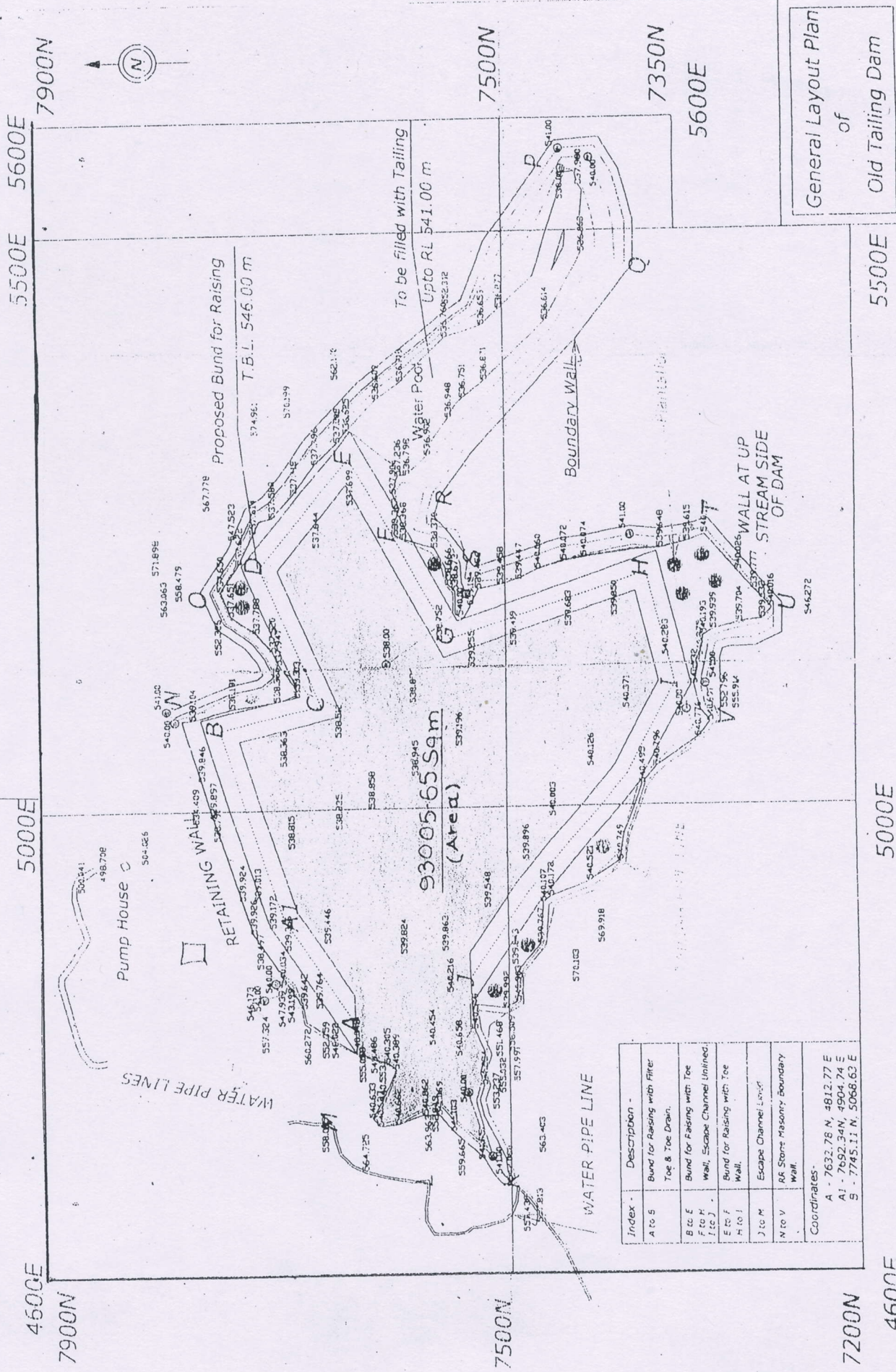

General Layout Plan
of
Old Tailing Dam

Index	Description
A to S	Bund for Raising with Filter Toe & Toe Drain.
B to E	Bund for Raising with Toe
F to H (etc.)	Wall, Escape Channel Unlined
E to F	Bund for Raising with Toe Wall.
H to I	Escape Channel Liner
J to M	RR Stone Masonry boundary
N to V	Wall.

Coordinates:
 A - 7632.78 N, 4812.77 E
 A1 - 7652.34 N, 4904.74 E
 S - 7745.11 N, 5068.63 E

Name of Work - **RAISING OF OLD TAILING DAM**
 Near Village BHEKHADA, JHAMAR KOTRA
 R.S.M.M. UDAIPUR

Client - **R.S.M.M. LTD.**
 4 MEERA MARG,
 UDAIPUR

Prepared & Submitted By - **WELMADE**
 WATER, ENVIRONMENT & LAND MANAGEMENT
 ADVISORS AND DEVELOPMENT EXPERTS
 2/3, YASH VIHAR, FATEHPURA, UDAIPUR
 E MAIL - gpbson@gmail.com

Drawing No - **PSM / O.E. T.Dam / 3**
 Date - **11.12.2013**

Print as -
 (a) Paper - A3
 (b) Plot Scale - 1 m = 3400 units
 (c) Plot offset - x = 30 mm, y = 5 mm



Civil Engineering Department
College of Technology and Engineering
(MAHARANA PRATAP UNIVERSITY OF AGRICULTURE & TECHNOLOGY)
Udaipur - 313001

No. CTAE/Civil/2018/ 26

Dated : 08.01.2018

To,
Group General Manager
Jhamarkotra Mines, RSMML

Site : Tailing Dam.

Ref : Letter No.- RSMML/Phos/Engg.(C)/2017-18/1411 Dt. 16.12.2017

Dear Sir,

The Material sample as supplied by you have been tested and the results are as follows:

Testing Report

	Sample - 1	Sample - 2	Sample - 3
1.. Grain size Analysis			
(a) Gravels ($\geq 4.75\text{mm}$)	Nil %	Nil %	Nil %
(b) Fine sand ($600 \mu - 75 \mu$)	17.8%	21.5%	17.2 %
(c) Silt & clay ($\leq 75 \mu$)	82.2%	78.5%	82.8 %
(d) Clay	Nil	Nil	Nil
4. Plasticity Test			
(b) Liquid Limit	Non Plastic	Non Plastic	Non Plastic
(b) Plastic Limit			
(c) Plasticity Index			
5. Density Test (Standard Proctor Test)			
(a) M.D.D.	1.91 g/cc	1.89g/cc	1.90g/cc
(b) O.M.C.	12 %	14 %	13 %
4 Direct Shear test C Φ	0.036Kg/cm ² 22 ^o	0.028Kg/cm ² 23 ^o	0.04kg/cm ² 19.5 ^o

The testing charges has been deposited vide Challan No. 7905 dt. 21.12.2017

(Testing Incharge)

COUNTERSIGNED

HEAD

Deptt. of Civil Engg

